

S t a n d a r d F e a t u r e s

LIVING FEATURES

Natural oak cabinetry
 Custom floor plans and interiors
 Walk-in bedroom closet
 AM/FM cassette in dash
 AM/FM cassette stereo in bedroom
 (2) 20" remote control color TVs
 Stereo VCR connected to both TVs
 Solid surface counter tops in living room, galley, and bedroom
 Cultured marble vanity and shower walls
 Fully tiled kitchen and bath floors
 Leather pilot & co-pilot seats with six-way power adjuster
 Dometic side-by-side refrigerator/freezer
 Ice maker
 Blender
 Instant Hot hot water dispenser
 Sharp micro-convection oven
 Two-burner LP cook top with lift-off lid
 Aqua Hot diesel-fired hot water heat system with three zones and heat for plumbing bay
 (3) 13,500 BTU low-profile fully-ducted roof airs
 Electric heat in living room and bath
 Water purification system
 Fantastic fan in bath with rain sensor
 Kool-O-Matic roof vent in kitchen

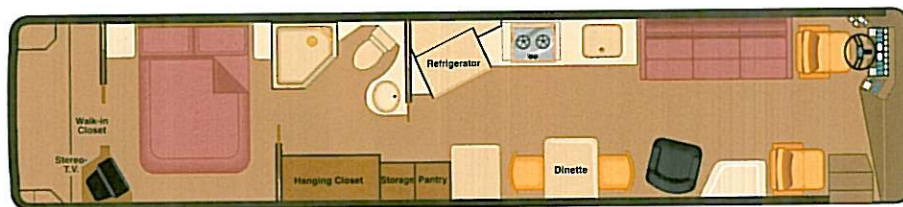

Dual water pumps
 40-channel CB
 Radar detector
 Sentrek compass/thermometer
 Solid-state musical horn
 Dual remote control and heated outside rear-view mirrors
 Defroster elements in forward section of pilot/co-pilot windows
 Musical door bell
 PMMI musical horn
 Electric lock at entrance door
 Air lock on entrance door
 Safeline shoreline alarm
 Power dump valves for holding tanks
 Under bed storage with gas cylinder lift assist

M E C H A N I C A L

Detroit Diesel Series 60 500-hp engine
 Allison six-speed HD4060 World transmission
 Ross TAS-85 integral power steering
 Trailing tag axle
 Tilt and telescoping steering column
 Ridewell air suspension in front, tag, and rear
 HWH computerized four-point leveling system
 15kW diesel generator in a sound-proof roll-out compartment
 300-AMP alternator
 Trace 3000-watt inverter with 140-AMP integral charger
 50-AMP electrical service
 45-gallon LP tank
 12R 22.5-H, 16-ply XZA Michelin steel cord radials
 Alcoa polished aluminum wheels with stainless steel hub and nut covers
 GVWR: 48,600 lbs.
 260-gallon diesel fuel tank
 Battery systems: (4) 4D gel cell batteries for house, (3) 12-volt maintenance-free for engine, and (1) 12-volt for generator
 Auxiliary start switch
 Cruise control

Racor fuel filter and water separator
 Engine block heater
 Direct injection bulk oil fill
 Ether injection quick start aid
 Individual mud flaps on front & rear
 A/T anti-theft switch
 Electronic master switch
 Air-operated stepwell cover
 HVAC automotive dash heat and air system

E X T E R I O R

Lowered engine deck
 Steel body construction
 Front and rear fiberglass caps
 102" wide body
 247" wheelbase
 Carpet-lined and lighted bus storage below
 Foamed-in-place insulation
 Audible reverse warning system
 Sony rear-vision closed-circuit TV system
 Back-up flood lamps
 Docking lights
 High-intensity spot/flood light
 Locking fuel doors
 Electric entry step
 Lighted utility center
 Engine compartment illumination
 Cellular phone antenna
 Roof-mounted TV antenna on a power lift
 Auxiliary air outlet
 Awnings on patio curb side, bedroom windows, kitchen, and road side of living room
 Electric grill on slide-out tray
 Dual air horns on roof
 Keyless entry
 Outside water compartment
 Toolbox on slide-out tray

LIVING FEATURES

Natural oak cabinetry
Custom floor plans and interiors
Walk-in bedroom closet
Premium sound with 10-disk player in dash
AM/FM cassette stereo in bedroom
(2) 20" remote control color TVs
Stereo VCR connected to both TVs
Solid surface counter tops in living room, galley, and bedroom
Cultured marble vanity and shower walls
Fully tiled kitchen and bath floors
Leather pilot seat with six-way power adjuster and air ride base
Leather co-pilot seat with six-way power adjuster
Dometic side-by-side refrigerator/freezer
Ice maker
Blender
Instant Hot hot water dispenser
Sharp micro-convection oven
Two-burner LP cook top with lift-off lid
Aqua Hot diesel-fired hot water heat system with three zones and heat for plumbing bay
(3) 13,500 BTU low-profile fully-ducted roof airs
Electric heat in living room and bath
Water purification system
Fantastic fan in bath with rain sensor
Kool-O-Matic roof vent in kitchen
Dual water pumps
40-channel CB
Radar detector
Sentrek compass/thermometer
Solid-state musical horn
Dual remote control and heated outside rear-view mirrors
Defroster elements in forward section of pilot/co-pilot windows
Musical door bell
PMMI musical horn
Electric lock at entrance door
Air lock on entrance door

Safeline shoreline alarm
Power dump valves for holding tanks
Under bed storage with gas cylinder lift assist

M E C H A N I C A L

Detroit Diesel Series 60 500-hp engine
Allison six-speed HD4060 World transmission
Ross TAS-85 integral power steering
Liftable tag axle
Tilt and telescoping steering column
Ridewell air suspension in front, tag, and rear
HWH computerized four-point leveling system
Generator auto start
15kW diesel generator in a sound-proof roll-out compartment
300-AMP alternator
(2) Trace 3000-watt inverters with 140-AMP integral chargers
50-AMP electrical service
45-gallon LP tank
12R 22.5-H, 16-ply XZA Michelin steel cord radials
Alcoa polished aluminum wheels with stainless steel hub and nut covers
GVWR: 50,600 lbs.
300-gallon diesel fuel tank
Battery systems: (6) 4D gel cell batteries for house, (3) 12-volt maintenance-free for engine, and (1) 12-volt for generator
Auxiliary start switch
Cruise control
Racor fuel filter and water separator
Engine block heater
Direct injection bulk oil fill
Ether injection quick start aid
Individual mud flaps on front, full width on rear
A/T anti-theft switch
Electronic master switch
Air operated stepwell cover
HVAC automotive dash heat and air system

E X T E R I O R

Lowered engine deck
Steel body construction
Front and rear fiberglass caps
102" wide body
259" wheelbase
Carpet-lined and lighted bus storage below
Foamed-in-place insulation
Audible reverse warning system
Sony rear-vision closed-circuit TV system
Back-up flood lamps
Docking lights
High-intensity spot/flood light
Engine compartment illumination
Wired and plumbed for auxiliary air compressor
Full awning package with chairs
Locking fuel doors
Electric entry step
Lighted utility center
Cellular phone antenna
Roof-mounted TV antenna on a power lift
Auxiliary air outlet
Electric grill on slide-out tray
Dual air horns on roof
Keyless entry
Outside water compartment
Toolbox on slide-out tray

